



No. 239

Date 9/19/90

Another addition to the expanding line of Webb products.

NEW PRODUCT BULLETIN

PART NUMBER: **54103**

ROTOR

SIZE: **14.75 × 1.34**

AVAILABLE
NOW

ESTIMATED WEIGHT: **36 Lbs.**

APPLICATION INFORMATION
SCHOOL BUS / LIGHT TRUCK

DIMENSIONAL INFORMATION

WEBB ROTOR	WEIGHT	ROTOR TYPE	A	B	C	D	E	F	
			DISC DIAMETER	DISC THICKNESS	OVERALL DEPTH	PILOT DIAMETER	BOLT CIRCLE DIAMETER	NUMBER	SIZE
54102	36	HAT	14.75	1.34	3.81	5.40	7.25	6	.78

<p>TYPE <u>HAT</u></p> <p>SEE REVERSE SIDE</p> <p>ROTOR CONFIGURATION</p>	<p>INTERCHANGE INFORMATION</p> <table border="1"> <thead> <tr> <th><u>MANUFACTURER</u></th> <th><u>PART NUMBER</u></th> </tr> </thead> <tbody> <tr> <td>BENDIX</td> <td>141269</td> </tr> <tr> <td>DAYTON</td> <td>122700</td> </tr> <tr> <td>FORD</td> <td>E4HZ-1125-A</td> </tr> </tbody> </table>	<u>MANUFACTURER</u>	<u>PART NUMBER</u>	BENDIX	141269	DAYTON	122700	FORD	E4HZ-1125-A
<u>MANUFACTURER</u>	<u>PART NUMBER</u>								
BENDIX	141269								
DAYTON	122700								
FORD	E4HZ-1125-A								

INTERCHANGE INFORMATION SHOWN ABOVE IS BASED ON INFORMATION AVAILABLE AT TIME OF PUBLICATION, PORTIONS OF WHICH WERE OBTAINED FROM UNCONFIRMED SOURCES. THEREFORE ACCURACY OF INTERCHANGE INFORMATION CANNOT BE ASSURED.

WEBB WHEEL PRODUCTS, INC.
 2310 Industrial Drive, S.W.
 Cullman, Alabama 35055
 (205) 739-6660
 FAX: 205-739-6246

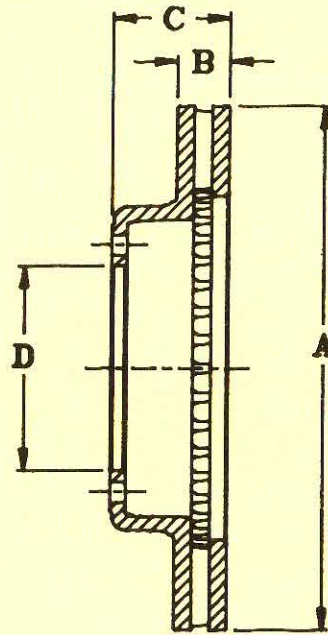
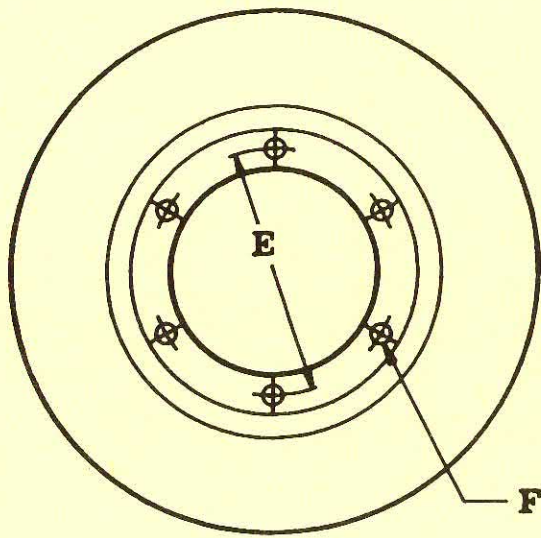

HAT TYPE