

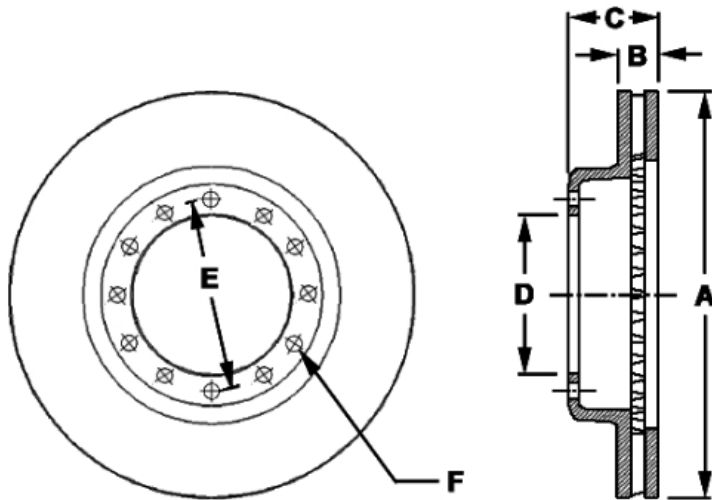

# NEW PRODUCT BULLETIN # 416

**53306P**

**Type HAT**



Rotor Configuration

**PART NUMBER:**  
53306P

**DESCRIPTION:**  
Disc Brake Rotor (ABS)

**SIZE:**  
14.29 x 1.65

**ESTIMATED WEIGHT:**  
42 lbs.

| Part Number | Weight | Type | A             | B              | C             | D              | E                    | F          |      |
|-------------|--------|------|---------------|----------------|---------------|----------------|----------------------|------------|------|
|             |        |      | Disc Diameter | Disc Thickness | Overall Depth | Pilot Diameter | Bolt Circle Diameter | Bolt Holes |      |
|             |        |      |               |                |               |                |                      | Number     | Size |
| 53306P      | 42     | HAT  | 14.29         | 1.65           | 3.96          | 4.33           | 5.35                 | 12         | .48  |

*(-P) indicates that the rotor is packaged. Webb rotors are packaged for protection.*

## INTERCHANGE INFORMATION

| Webb Number | Competitor    |
|-------------|---------------|
| 53306P      | 980066        |
|             | 8-98105-272-0 |
|             | 29404R7300    |

THE INTERCHANGE INFORMATION SHOWN ABOVE IS BASED ON INFORMATION AVAILABLE AT THE TIME OF PUBLICATION PORTIONS WHICH WERE OBTAINED FROM UNCONFIRMED SOURCES. THEREFORE, ACCURACY OF INTER- CHANGE INFORMATION CANNOT BE ASSURED.